

# 290mm Flat Truss Data Sheet

# Titan AV

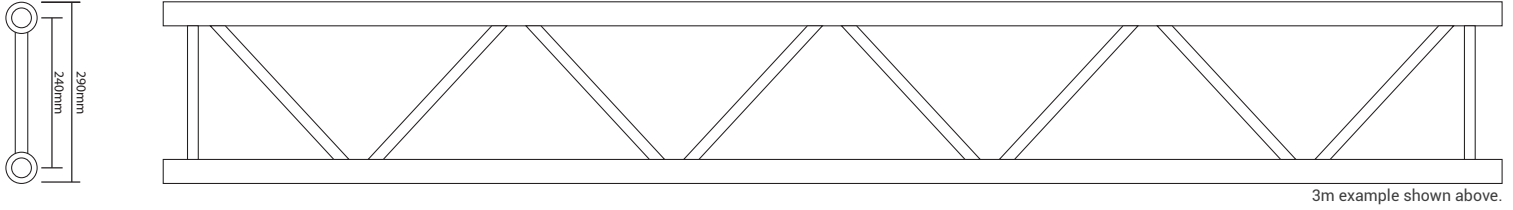

3m example shown above.

### Certifications and compliance

Report No: 20164068M01  
 Independent Inspection & Testing Company: Alfa Test (ISO17025 & Nata Accreditation)  
 Location of Test: Alfa Test, Brisbane Laboratory, Qld

### Static load test & results

Test Procedure: TP 230  
 Test Spec: TP 230  
 Requirements: Uniformly loaded with 25kg weights at 1-meter increments & Centre point loaded with 53kg weights.  
 Tested length: Uniformly loaded over 6m span, Centre point loaded over 6m span.  
 Test Results: PASS

### Product specification

Description: Aluminium Flat Truss System 300 x 50mm (Industry standard 290 truss)  
 Brand: Titan AV  
 Model Number: TR-SF30  
 Product Specification:

- Connecting Cross Section: 240mm x 25mm
- Material (Main Tube, Brace & End connector): Aluminium 6082-T6
- Main Tubes: 50mm x 2 mm
- Braces: 20mm x 2mm



### Titan AV 290mm Flat Truss Allowable Loading\* (TR-SF30)

Span	Uniformly Distributed Load (UDL)	Deflection	Centre Point Load (CPL)	Deflection
M	KG/M	MM	KG	MM
1	845.0	0.0	845.0	0.0
2	418.0	3.0	623.0	2.0
3	218.0	6.0	345.0	5.0
4	95.0	13.0	202.0	11.0
5	43.0	21.0	114.0	17.0
6	20.0	30.0	53.0	24.0

### Titan AV 290mm Flat Truss Product Range

VFM Part ID	Length	Weight of Length	Approved For Rigging
TR-SF30-050	0.5 m	3.0 kg	Y
TR-SF30-100	1.0 m	4.0 kg	Y
TR-SF30-150	1.5 m	5.0 kg	Y
TR-SF30-200	2.0 m	7.0 kg	Y
TR-SF30-250	2.5 m	8.0 kg	Y
TR-SF30-300	3.0 m	9.0 kg	Y

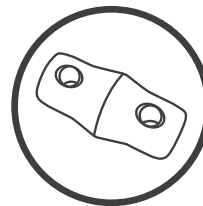

2 x Spigots included as standard

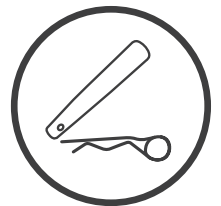

4 x Clips and Pins included as standard

\* PLEASE NOTE: Load table information is supplied as a guide only. Please consult your structural engineer for advice related to your application.



Unit 8, 50 Raubers Road Banyo QLD 4014  
 P: (07) 3423 3463  
 E: [sales@vfmaudio.com.au](mailto:sales@vfmaudio.com.au)  
 W: [www.vfmaudio.com.au](http://www.vfmaudio.com.au)



Click to follow